

THE STRONGEST LINK.



THE SMARTEST CONNECTION IS ALSO THE SAFEST

miniCON type 8595 plug-in connectors by R. STAHL

ONE CONNECTOR – MANY SYNERGIES

miniCON is the simplest, safest and most reliable way to connect your devices with power sources, data networks or each other: **modular, mobile, maintenance-free** and made for hazardous areas and harsh environments. Constructed from stainless steel or rugged plastics, it offers many advantages and benefits wherever industrial plug-in connectors are needed.

miniCON Highlights

- 1. Minimises downtime** as it can be replaced by only one employee during operation (hot swap). Supports new maintenance strategies such as predictive or condition-based maintenance.
- 2. Eliminates errors and troubleshooting** in the plant because all connectors are already pre-assembled and tested by the OEM. Mixing up connections is impossible – guaranteed.
- 3. Saves money** by reducing installation time, speeding up commissioning and improving plant availability. In addition, it only requires one type of connector in your warehouse that can be used for all applications.

Twist-lock system

Patented torsional locking mechanism that establishes easier mechanical and electrical connections “with a twist”.

Unmistakable plugs

“Self-finding” system with three coding options for plugs that simply cannot connect with anything they shouldn’t connect with.

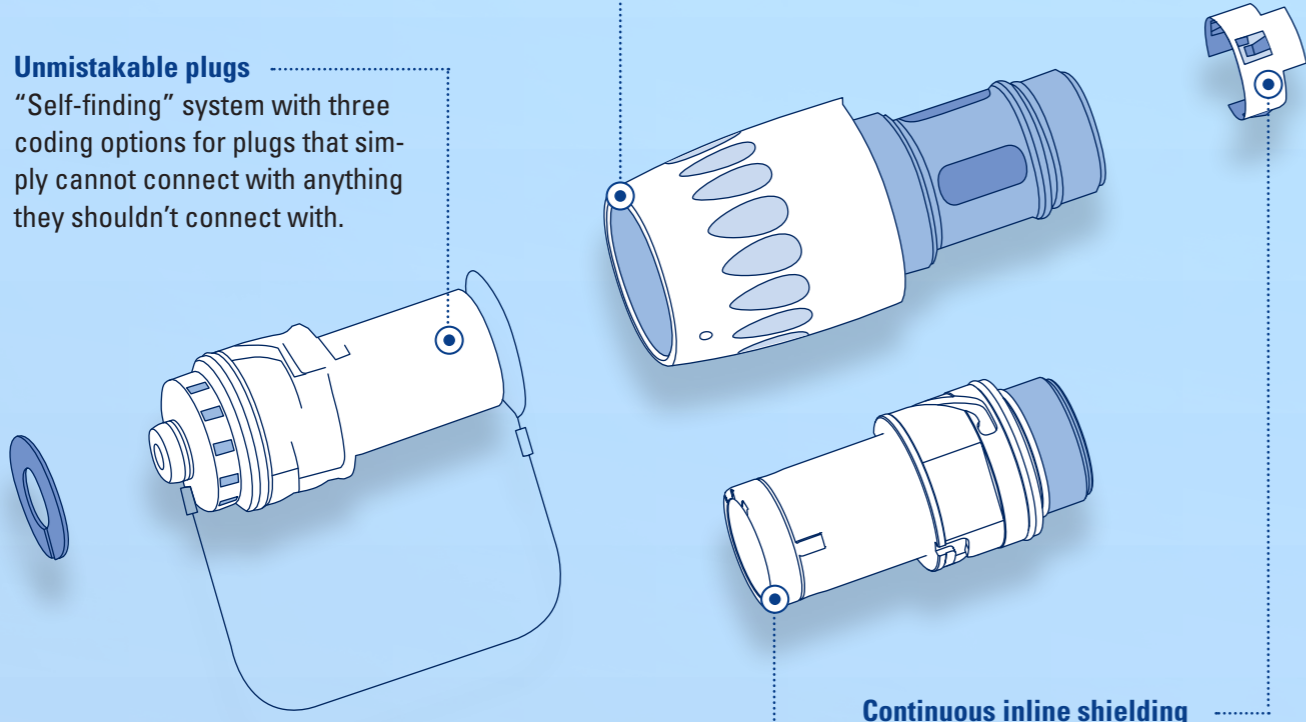

Ready for Ex e and Ex d

Modular connectors for quick and simple adaptability to multiple Ex zones and safety requirements.

Continuous inline shielding

Sophisticated shielding concept for minimised electrical or electromagnetic interference effects (EMC).

Multiple application possibilities:

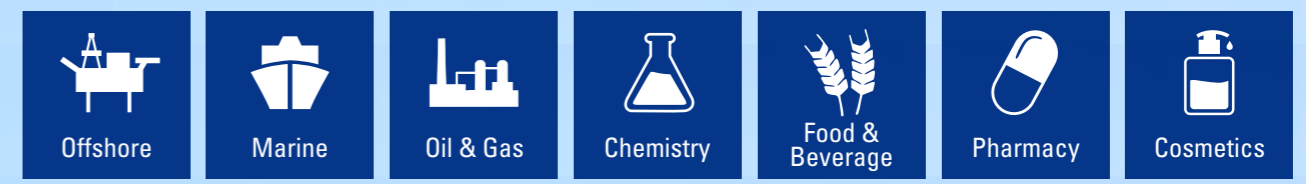

Various pin connection options

Supports all electrical connections from bus systems to three-phase power supply (8-pole or 7-pole + PE, high-speed bus, 3-phase + auxiliary contact) to give you full freedom for all applications.

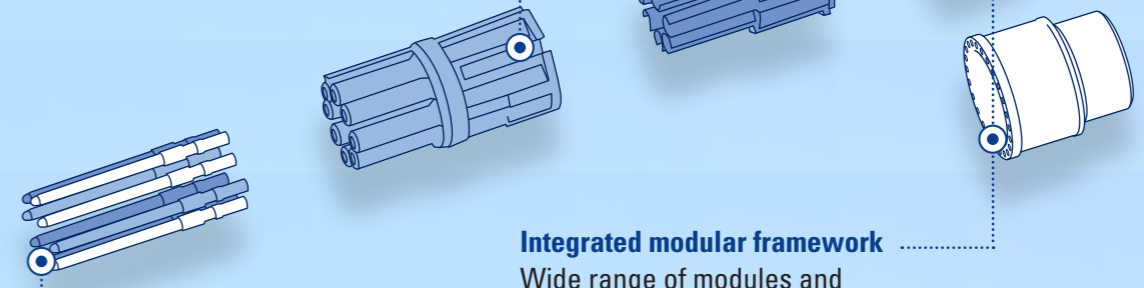

Integrated modular framework

Wide range of modules and adapters for almost any possible purpose and application in Ex e or Ex d environments.

Flexible cable cross section

Contact elements for cable cross sections from 0.25 mm² to 2.5 mm² provide safe connections to your terminal devices.

Universally simple and flexible

Easy installation and maintenance in Ex e and Ex d enclosures due to clear and self-explanatory construction from modular parts.

miniCON is **easy to use**, even with working gloves, and precludes faulty connections via its coding system. It's uniquely **flexible** because miniCON is a modular platform with “extensions” that enable a **wide variety of solutions**. And it's made for the future, supporting your maintenance strategies and **improving plant availability** through fast response times.

TECHNICAL DATA	
TEMPERATURE RANGE	-60 °C to +75 °C
BREAKING CAPACITY	500V AC / 16 A 110V DC / 8A hot swap capable
EX ZONES	Zone 1, 2, 21 & 22, IIC, Class I Div. 2, Class I Zone 1
IP PROTECTION	IP66 & IP68 (IEC60529)
CERTIFICATION	ATEX, IECEx, EAC, cULus

CONNECT TO THE FUTURE

If your plant could benefit from foolproof, maintenance-free connectors that are quick and easy to install, save you storage costs and guarantee plant availability, then miniCON is designed for you. So let's get in touch and we'll show you how easy we have made it to get a perfect connection.



miniCON with Ex e enclosure



miniCON with Ex d enclosure

ID 294923 | 2021-10 / EN | Printed in Germany



R. STAHL
Am Bahnhof 30
74638 Waldenburg, Germany
T +49 7942 943-0
E sales.de@r-stahl.com
r-stahl.com/en/minicon

Follow us:

 R. STAHL Group
 R. STAHL Group
 @rstahlgroup