

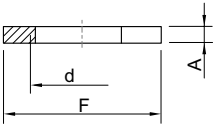

MY R. STAHL ACC1B

| Selection Table | | | | | | |
|---|-------------|------------------------------------|--------|----------|----------|---------|
| Construction type Material incl. surface coating | | Hexagon nut Nickel-plated brass | | | | |
| Thread size | MY R. STAHL | Width across flats | Height | Lot size | Art. No. | Weight |
| M12 | ACC1B | 15 mm | 3 mm | 100 | 241518 | 220 g |
| M16 | ACC1B | 19 mm | 3 mm | 100 | 241519 | 290 g |
| M20 | ACC1B | 24 mm | 3 mm | 100 | 241520 | 480 g |
| M25 | ACC1B | 29 mm | 3.5 mm | 100 | 241561 | 720 g |
| M32 | ACC1B | 36 mm | 4 mm | 50 | 241562 | 545 g |
| M40 | ACC1B | 46 mm | 4.5 mm | 50 | 241563 | 1.03 kg |
| M50 | ACC1B | 55 mm | 5 mm | 25 | 241564 | 680 g |
| M63 | ACC1B | 70 mm | 5.5 mm | 10 | 241565 | 499 g |
| NPT1/2" | ACC1B | 27 mm | 4.8 mm | 100 | 253047 | 1.16 kg |
| NPT1-1/2" | ACC1B | 60 mm | 5 mm | 50 | 253051 | 1.64 kg |
| NPT1-1/4" | ACC1B | 50 mm | 4.8 mm | 50 | 253050 | 1.5 kg |
| NPT1" | ACC1B | 41 mm | 4.8 mm | 100 | 253049 | 1.6 kg |
| NPT2-1/2" | ACC1B | 84 mm | 10 mm | 10 | 253053 | 1.5 kg |
| NPT2" | ACC1B | 75 mm | 5 mm | 25 | 253052 | 1.38 kg |
| NPT3/4" | ACC1B | 33 mm | 4.8 mm | 100 | 253048 | 1.25 kg |
| NPT3" | ACC1B | 100 mm | 10 mm | 10 | 253054 | 3.77 kg |
| Construction type Material incl. surface coating | | Hexagon nut Polyamide | | | | |
| Thread size | MY R. STAHL | Width across flats | Height | Lot size | Art. No. | Weight |
| M12 | ACC1B | SW18 | 5 mm | 100 | 239460 | 1 g |
| M16 | ACC1B | SW22 | 5 mm | 100 | 239461 | 2 g |
| M20 | ACC1B | SW27 | 5 mm | 100 | 239462 | 2 g |
| M25 | ACC1B | SW32 | 6 mm | 100 | 239463 | 3 g |
| M40 | ACC1B | SW50 | 7 mm | 50 | 239465 | 7 g |
| M50 | ACC1B | SW60 | 7 mm | 25 | 239466 | 12 g |
| M63 | ACC1B | SW75 | 7 mm | 10 | 239467 | 18 g |

Lot size: Purchase order quantity in [no. of units]; the delivery quantity is automatically rounded to the lot size.



F = Width across flats d = Thread size A = Height