

# Lighting

## Linear luminaire With LED

### GRP industrial design

L402/4324-6120-152-1110-11-865S Art. No. 289700



- Highly resistant industrial design
- Linear luminaire with long-life, efficient LED technology (up to 138 lm/W)
- Lightweight yet extremely robust, with an impact strength rating of IK10

## MY R. STAHL L402A

The EXLUX L402/4 luminaire is designed for industrial use and can be fitted to the ceiling, a pole, or alternatively, it can be suspended. A bright light for not much energy is what you get with this efficient LED technology, which offers the added benefit of increased service life – this can be as much as 100,000 hours. The plastic enclosure is easily to open by a central lock.

## Technical Data

| Explosion Protection                |   |
|-------------------------------------|---|
| Ex version                          | Industrial design   |
| Electrical Data                     |   |
| Rated operational voltage AC        | 220 ... 230 V   |
| Rated operational voltage DC        | 194 ... 250 V   |
| Frequency range                     | 50 – 50Hz   |
| Lighting Data                       |   |
| Number of lamps                     | 1   |
| Lamp wattage                        | 22 W  |
| Lamp                                | LED   |
| Light colour                        | 6500 K – daylight white   |
| Light distribution                  | 120°x120°   |
| Luminaire efficacy                  | 116 lm/W  |
| Luminous flux                       | 2550 lm   |
| Colour rendering                    | ≥ 80  |
| Colour temperature                  | 6500 K  |
| Ambient Conditions                  |   |
| Ambient temperature                 | -30 °C ... 45 °C Note: Through wiring Max. 3x16 A<br>-30 °C ... 50 °C Note: Through wiring 2 Max. 3x10 A  |
| Note                                | Through wiring max. 3x16 A<br>Ambient temperature °C -40 °C ... +55 °C<br>Through wiring 2 max. 3x10 A<br>Ambient temperature °C 2 -40 ... +60 °C |
| Mechanical Data                     |   |
| Version                             | Standard  |
| IP degree of protection (IEC 60598) | IP66/IP67   |
| Class                               | I (with inner PE connection)  |
| Enclosure material                  | Polyester resin, Glass fibre reinforced   |

# Lighting

## Linear luminaire With LED

### GRP industrial design

L402/4324-6120-152-1110-11-865S Art. No. 289700



#### Mechanical Data

|   |                          |
|---|--------------------------|
| Enclosure colour                          | Light grey (RAL 7035)    |
| Diffuser                                  | Without diffuser         |
| Sealing material                          | Silicone                 |
| Silicone-free content                     | Contains silicone        |
| Translucent cover material                | Polycarbonate            |
| Installed terminal strip                  | PE + N- + L+ + N' + L'   |
| Max. solid connection terminals           | 6 mm <sup>2</sup>        |
| Max. finely stranded connection terminals | 4 mm <sup>2</sup>        |
| Type of connection cable                  | Finely stranded<br>Solid |
| Size                                      | 2                        |
| Width                                     | 184 mm                   |
| Height                                    | 125 mm                   |
| Length                                    | 700 mm                   |
| Impact strength (IEC 62262)               | IK10                     |
| Weight                                    | 3.3 kg                   |
| Weight                                    | 7.28 lb                  |
| Disconnection of the luminaire            | No                       |

#### Components

|                          |                                       |
|--------------------------|---------------------------------------|
| Threaded plate           | 2x plastic                            |
| Address module           | UNI Modul ADR 20-ILS-Z2               |
| Ballast                  | VG Luxtronic 40 W 300 mA              |
| Through wiring           | With 5 conductors 2.5 mm <sup>2</sup> |
| Drilled holes            | 3 x M25                               |
| Cable glands and entries | 2 x M25 Ø 7 ...                       |
| Material cable gland     | Polyamide, black                      |
| Stopping plugs           | 2 x M25 x 1.5                         |
| Stopping plug material   | Polyamide, black                      |
| Accessories              | Provided                              |

#### Light Distribution Curves

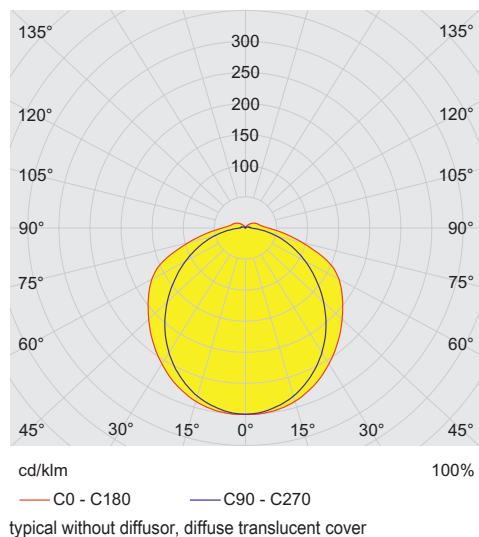

# Lighting

## Linear luminaire With LED

### GRP industrial design

L402/4324-6120-152-1110-11-865S Art. No. 289700



#### Dimensional Drawings (All Dimensions in mm [inches]) – Subject to Alterations

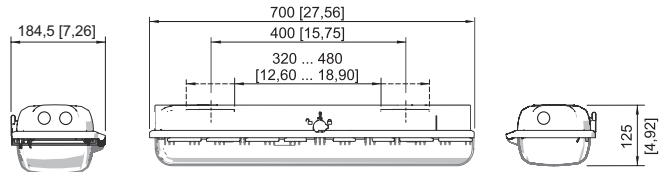

Size 2

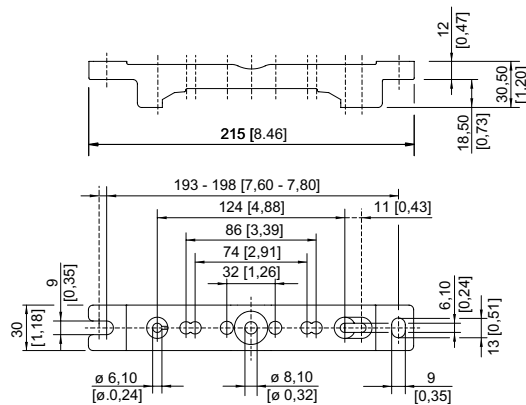

Mounting rail

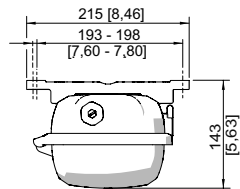

Mounting rail

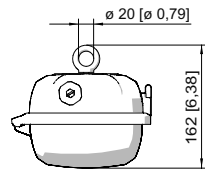

Ring bolt fitted in insert nut of the luminaire

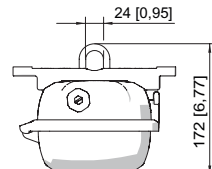

Mounting bracket fitted in mounting rail

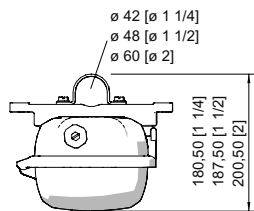

Pipe clamp fitted in mounting rail

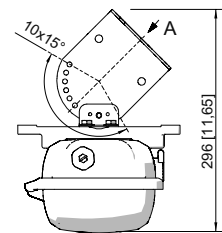

A

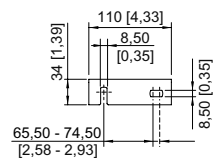

Wall mounting bracket fitted in mounting rail

## Accessories

### Box spanner

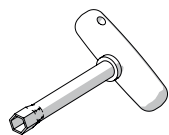

M8 / A/F 13;  
For actuating the central lock

Art. No.

222430

### Breather

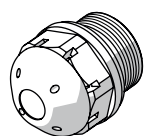

Thread: M25 x 1.5 (20 pieces); without jam nut

Art. No.

285780

# Lighting

Linear luminaire With LED

GRP industrial design

L402/4324-6120-152-1110-11-865S Art. No. 289700



|  |  |                 |
|--|--|-----------------|
|  | Thread: M25 x 1.5 (1 piece); for installation in light fittings; made from stainless steel; without jam nut  | 296608          |
|  | M25 x 1.5 in order to avoid condensate formation   | 115738          |
| <b>Ceiling and wall mounting bracket</b> |  | <b>Art. No.</b> |
|  | mounted on a mounting rail for a variable mounting distance; Material: stainless steel; Lamp can be swiveled in steps of 15°; 1 pair                   | 222827          |
| <b>Cover</b>                             |  | <b>Art. No.</b> |
|  | For size 2 luminaires (diffuse), when used on an emergency luminaire with individual power supply, the visibility of the display LED may be restricted | 276669          |
| <b>Holder for translucent cover</b>      |  | <b>Art. No.</b> |
|  | The fall prevention system for the light fitting cover prevents the light fitting cover from falling accidentally when the light fitting is opened.    | 226791          |
| <b>Mounting bracket</b>                  |  | <b>Art. No.</b> |
|  | mounting clamp mounted on a mounting rail for a variable mounting distance; 1 pair   | 222456          |
| <b>Mounting rail</b>                     |  | <b>Art. No.</b> |
|  | for a variable mounting distance; 1 pair   | 222826          |
| <b>Pipe clamp</b>                        |  | <b>Art. No.</b> |
|  | R 1 1/2"; with mounting rail for a variable mounting distance; material: stainless steel; 1 pair   | 222459          |
|  | R 1 1/4"; with mounting rail for a variable mounting distance; Material: stainless steel; 1 pair   | 222458          |
|  | R 2"; with mounting rail for a variable mounting distance; Material: stainless steel; 1 pair   | 222460          |
| <b>Pole mounting sleeve</b>              |  | <b>Art. No.</b> |
|  | for the subsequent mounting on lights size 2 and size 4, completely with assembly parts (for pipe diameter 42 mm)                                      | 227512          |

# Lighting

Linear luminaire With LED

GRP industrial design

L402/4324-6120-152-1110-11-865S Art. No. 289700



## Protection against accidental contact

Art. No.

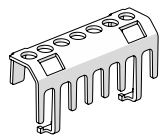

The protection against accidental contact prevents maintenance technicians and electrical installers from accidentally touching conductive parts. The degree of protection is increased to IP20 when the protection against accidental contact is used.

283153

## Ring bolt

Art. No.



M8, direct mounting in insert nuts; 1 pair

115736

We reserve the right to make alterations to the technical data, dimensions, weights, designs and products available without notice. The illustrations cannot be considered binding.