

8006/4-026-00 Art. No. 169504



- Can be used as motor, main or load disconnect switches, as well as control switches
- Rated operational voltage up to 690 V AC and 220 V DC
- Different switching arrangements available

MY R. STAHL 8006B



R. STAHL Series 8006/4 load and motor switches have isolating characteristics and AC-3 and DC-23 switching capacity. This makes them suitable for use as motor switches or main switches. They can also be used as control switches. They are available with different switching arrangements, from 2-pole to 12-pole.

### Technical Data

#### Explosion Protection

|                                |  |
|--------------------------------|--|
| Application range (zones)      | 1, 2   |
| IECEX gas certificate          | IECEX PTB 06.0018U   |
| IECEX gas explosion protection | Ex db eb IIC T6 Gb   |
| ATEX gas certificate           | PTB 01 ATEX 1021 U   |
| ATEX gas certificate           | PTB 01 ATEX 1021 U   |
| ATEX gas explosion protection  | Ex II 2 G Ex db eb IIC T6 Gb   |
| FMus certificate               | 3044997  |
| cFM certificate                | 3044997C   |
| cULus certificate              | 20131017-E182378   |
| Marking ULus                   | Class I, Zone 1 AEx db eb IIC T6 Gb<br>Class I, Div. 2, Groups A,B,C,D   |
| Marking cUL                    | Class I, Zone 1 Ex db eb IIC T6 Gb<br>Class I, Div. 2, Groups A,B,C,D  |
| Certificates                   | ATEX (PTB), Brazil (ULB), Canada / USA (UL), Canada (FM), Canada (UL), China (CQST), IECEX (PTB), USA (FM), USA (UL) |

#### Electrical Data

|                                  |                              |
|----------------------------------|------------------------------|
| DC rated operational voltage     | 220 V                        |
| Rated operational voltage AC UL  | 600 V                        |
| Rated operational current for AC | 690 V / 25 A<br>500 V / 32 A |
| Rated operational current for DC | 25 A                         |
| Rated operational current UL     | 25 A                         |
| Short-circuit strength           | 20 kA                        |
| Max. short-circuit protection    | 35 A                         |
| Tripping characteristic          | gG                           |
| No. of poles                     | 5                            |

8006/4-026-00 Art. No. 169504

### Ambient Conditions

|                          |                   |
|--------------------------|-------------------|
| Ambient temperature      | -50 °C ... +70 °C |
| Ambient temperature (UL) | -60 °C ... +80 °C |

### Mechanical Data

|  |                                      |
|--|--------------------------------------|
| Degree of protection (IP)                      | IP00                                 |
| Enclosure material                             | Epoxy resin                          |
| Contact material                               | Silver stannic oxide                 |
| Base   | Without connection                   |
| Connection cross-section                       | 6 mm <sup>2</sup>                    |
| Connection cross section min.                  | 1.5 mm <sup>2</sup>                  |
| Max. connection cross section, solid           | 6 mm <sup>2</sup>                    |
| Max. connection cross-section, finely stranded | 6 mm <sup>2</sup>                    |
| Number of switching positions                  | 5                                    |
| Assembly for swit. arrangement                 | 026                                  |
| Contacts                                       | 5 NO                                 |
| Service life, min.                             | 2 x 10 <sup>5</sup> operating cycles |
| Detailed number of poles                       | 5 P                                  |
| Weight   | 580 g                                |
| Weight   | 1.28 lb                              |

### Mounting / Installation

|                                     |                |
|-------------------------------------|----------------|
| Connection type                     | Screw terminal |
| Max. USA solid connection terminals | 10 AWG         |

### Technical Drawings – Subject to Alterations

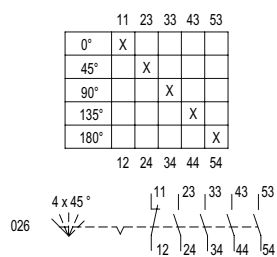

8006/4-026-00 Art. No. 169504

### Dimensional Drawings (All Dimensions in mm [inches]) – Subject to Alterations

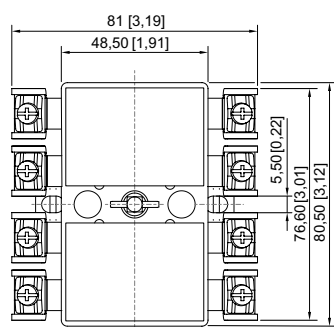
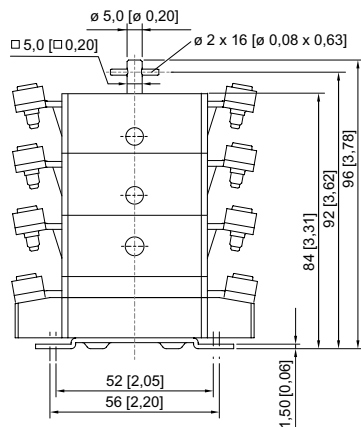

Load and motor switches Series 8006/4, 5-pole and 6-pole

### Accessories

#### IP20 cover

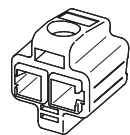

1 pc.  
An IP20 cover is required for each contact

Art. No.

204108

### Spare Parts

#### Ex i cover



for connecting intrinsically safe circuits (2 pcs)

Art. No.

213610

8006/4-026-00 Art. No. 169504

### Rotary actuator Maxi BG736



8602C3-736-B-XXX-E08  
 Ø 64 mm  
 Handle colour: Black  
 Protective collar colour: Black  
 Front panel mounting  
 -20 °C ... 60 °C  
 Silicone-free: Yes  
 Lockable option (max. 3 times) can be determined using the enclosed closing parts.  
 Lockable handle position: Not defined.  
 In the unmounted assemblies, the standard label is 0/OFF-I/ON and the long coupling part is enclosed.  
 Other labels must be ordered separately.

**Art. No.**  
318417

8602C3-736-S-XXX-E08  
 Ø 64 mm  
 Handle colour: Black  
 Protective collar colour: Black  
 Front panel mounting  
 -60 °C ... 70 °C  
 Silicone-free: No  
 Lockable option (max. 3 times) can be determined using the enclosed closing parts.  
 Lockable handle position: Not defined.  
 In the unmounted assemblies, the standard label is 0/OFF-I/ON and the long coupling part is enclosed.  
 Other labels must be ordered separately.

318418

### Rotary actuator Maxi BG737



8602C3-737-B-XXX-E08  
 Ø 64 mm  
 Handle colour: Red  
 Protective collar colour: Yellow  
 Front panel mounting  
 -20 °C ... 60 °C  
 Silicone-free: Yes  
 Lockable option (max. 3 times) can be determined using the enclosed closing parts.  
 Lockable handle position: Not defined.  
 In the unmounted assemblies, the standard label is 0/OFF-I/ON and the long coupling part is enclosed.  
 Other labels must be ordered separately.

**Art. No.**  
318419

8602C3-737-S-XXX-E08  
 Ø 64 mm  
 Handle colour: Red  
 Protective collar colour: Yellow  
 Front panel mounting  
 -60 °C ... 70 °C  
 Silicone-free: No  
 Lockable option (max. 3 times) can be determined using the enclosed closing parts.  
 Lockable handle position: Not defined.  
 In the unmounted assemblies, the standard label is 0/OFF-I/ON and the long coupling part is enclosed.  
 Other labels must be ordered separately.

318420

8006/4-026-00 Art. No. 169504

### Labels for rotary actuator Maxi BG736, BG737

Art. No.

|   |                           |        |
|---|---------------------------|--------|
|   | Dia. 58.5<br>0/OFF I/ON   | 274882 |
|   | Dia. 58.5<br>0 BETRIEB I  | 263982 |
|   | Dia. 58.5<br>0 I II       | 318507 |
|   | Dia. 58.5<br>I 0 II       | 318502 |
|  | Dia. 58.5<br>0/OFF • I/ON | 318459 |

We reserve the right to make alterations to the technical data, dimensions, weights, designs and products available without notice. The illustrations cannot be considered binding.