

# Load disconnect switches and motor starters

## Molded case circuit breaker for motor protection



8146/5-V27-110-115-10-21-1 Art. No. 249186



- Conductor and system protection for Ex e and Ex d motors
- Robust enclosure made of glass fibre reinforced polyester resin
- Optional: Undervoltage release, shunt trip, ammeter, auxiliary contact

MY R. STAHL 8146N



R. STAHL Series 8146/5-V27 moulded case circuit breakers for motor protection protect Ex e and Ex d motors as well as the associated conductors and systems. The standard versions feature an adjustable, phase-sensitive thermal overcurrent release or an electromagnetic quick release, which has to be specified during the ordering process. They cannot be retrofitted.

### Technical Data

#### Explosion Protection

Area of application	European Union (ATEX) IECEX
Application range (zones)	1, 2, 21, 22
IECEX gas certificate	IECEX PTB 06.0090
IECEX gas explosion protection	Ex db eb IIC T5 Gb
IECEX dust certificate	IECEX PTB 06.0090
IECEX dust explosion protection	Ex tb IIIC T95 °C Db
ATEX gas certificate	PTB 01 ATEX 1024
ATEX gas explosion protection	⊕ II 2 G Ex db eb IIC T5 Gb
ATEX dust certificate	PTB 01 ATEX 1024
ATEX dust explosion protection	⊕ II 2 D Ex tb IIIC T95 °C Db
Certificates	ATEX (PTB), Canada (FM), China (NEPSI), IECEX (PTB), India (PESO)
Declaration of conformity	ATEX (EUK), China (CCC)

#### Electrical Data

Frequency range	50 – 60 Hz
Switching capacity	16 kW
Release	Undervoltage release
AC release voltage	500 V
Release frequency	50 – 60 Hz
Current-setting range	9 – 12.5 A
Auxiliary contacts	without
No. of poles	3

#### Ambient Conditions

Ambient temperature	-20°C ... +40°C
Ambient temperature	-4 °F ... +104 °F

#### Mechanical Data

Degree of protection (IP)	IP66
---------------------------	------

# Load disconnect switches and motor starters

## Mlded case circuit breaker for motor protection



8146/5-V27-110-115-10-21-1 Art. No. 249186

### Mechanical Data

Degree of protection note	according to EN/IEC 60529
Enclosure material	Polyester resin, Glass fibre reinforced
Min. solid conn. cr.-sect. AWG	AWG 16
Max. connection cross section, solid AWG	AWG 8
Min. f.stra. con. cr.-sec. AWG	AWG 16
Width	112.5 mm
Width, inches	4.43 in
Height	227 mm
Height in inches	8.94 in
Depth	131 mm
Depth in inches	5.16 in
Handle colour	Black
Protective collar colour	Black
Rotary actuator labelling	0 - I
Seal	Silicone, foamed
Lockable in	Three times in 0 position
Weight	3.35 kg

### Components

Cable glands and entries	3 x M25 Ø 7 ... 17 mm
Type of screw connection	8161

### Dimensional Drawings (All Dimensions in mm [inches]) – Subject to Alterations

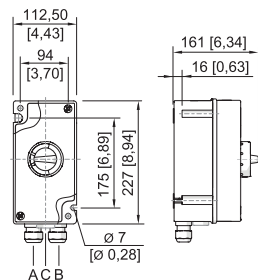

Current-setting range up to 16 A; without auxiliary contacts

### Cable entries

Version	Auxiliary contacts	Cable glands Series 8161		Stopping plugs Series 8290
		M25 x 1.5	M32 x 1.5	M25 x 1.5
Current-setting range up to 16 A	without	A, B	--	C
	with	A, B, C	--	--
Current-setting range 16 to 20 A, 20 to 22.5 A	without	--	A, B	C
	with	C	A, B	--

We reserve the right to make alterations to the technical data, dimensions, weights, designs and products available without notice. The illustrations cannot be considered binding.