

Lighting
Linear luminaire With LED
GRP



6602/1221-0100-152-2222-22-857 Art. No. 325355



- Smart Central Locking System – Allows effortless access for quick maintenance, minimizing downtime and enhancing operational efficiency.
- Advanced Surge Protection up to 2KV – Engineered for resilience, the robust design shields the luminaire from electrical surges, ensuring long-lasting performance.
- Superior Energy Efficiency – Achieves an outstanding 130 lumens per watt, delivering maximum illumination with minimal energy consumption.
- Long-Lasting LED Performance – Designed for durability, the luminaire delivers over 60,000 hours of service life even in +55°C ambient conditions.

MY R. STAHL 6602A

The 6602 linear LED luminaire is built to withstand harsh conditions, making it ideal for industries such as oil & gas, specialty chemicals, and pharmaceuticals and similar hazardous environments. With its high-performance illumination, it is perfect for lighting large surfaces at mounting heights of up to 10 meters, as well as illuminating equipment and objects both indoors and outdoors. For added flexibility, the luminaire can be easily mounted on poles using the pole mounting sleeve accessory, ensuring adaptable installation across various industrial settings.

Technical Data

Explosion Protection	
Ex version	Yes
Application range (zones)	2, 21, 22
IECEX gas certificate	IECEX IBE 24.0030
IECEX gas explosion protection	Ex nR IIC T6 Gc
IECEX dust certificate	IECEX IBE 24.0030
IECEX dust explosion protection	Ex tb IIIC T85 °C Db
Certificates	IECEX (IBE)
Electrical Data	
Rated operational voltage AC	220 ... 240 V
Rated operational voltage DC	220 ... 240 V
Frequency range	50 – 60 Hz
Lighting Data	
Number of lamps	1
Lamp wattage	22 W
Lamp	LED
Light colour	5700 K – cool white
Light distribution	120°x120° with diffusing glass
Luminaire efficacy	125 lm/W
Luminous flux	2837 lm
Colour rendering	≥ 80
Colour temperature	5700 K
Ambient Conditions	
Ambient temperature	-30 °C ... +55 °C Note: Through wiring Max. 3x10 A
Mechanical Data	
Version	Standard

Mechanical Data

IP degree of protection (IEC 60598)	IP66/IP67
Enclosure material	Polyester resin, Glass fibre reinforced
Enclosure colour	Light grey (RAL 7035)
Diffuser	With diffuser
Sealing material	Silicone
Silicone-free content	Contains silicone
Translucent cover material	Polycarbonate
Installed terminal strip	PE + N + L1 + L2 + L3
Max. solid connection terminals	6 mm ²
Max. finely stranded connection terminals	4 mm ²
Type of connection cable	Finely stranded Solid
Size	2
Width	184 mm
Height	125 mm
Length	700 mm
Impact strength (IEC 62262)	IK10
Weight	3.7 kg
Weight	8.16 lb
Disconnection of the luminaire	No

Components

Threaded plate	2x stainless steel
Ballast	Inventronics -OT FIT
Through wiring	With 5 conductors 2.5 mm ²
Drilled holes	4 x M20
Cable glands and entries	can be ordered as an accessory
Material cable gland	Polyamide, black
Stopping plugs	Can be ordered as accessories
Accessories	without

Light Distribution Curves

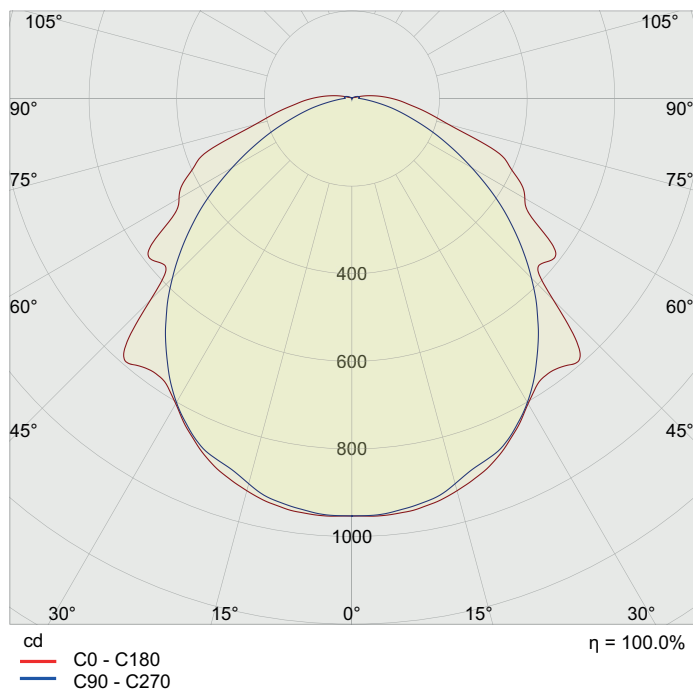

Size 2

Dimensional Drawings (All Dimensions in mm [inches]) – Subject to Alterations

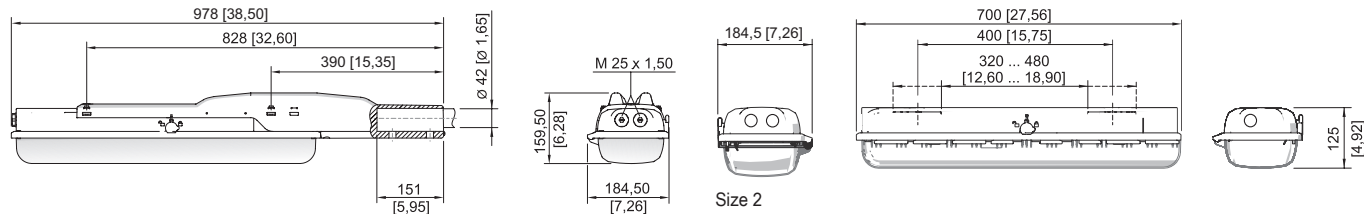

Size 2

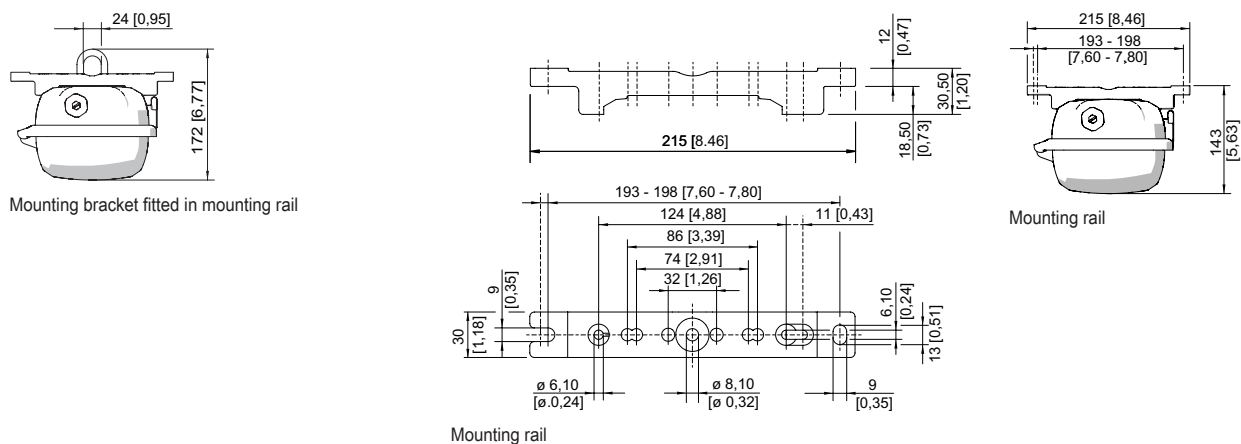

Lighting

Linear luminaire With LED

GRP

6602/1221-0100-152-2222-22-857 Art. No. 325355

STAHL

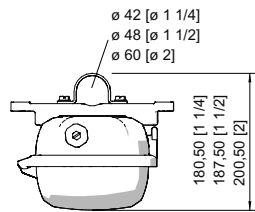

Pipe clamp fitted in mounting rail

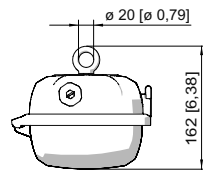

Ring bolt fitted in insert nut of the luminaire

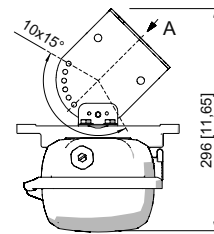

A

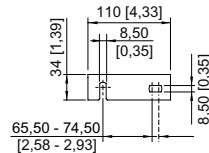

Wall mounting bracket fitted in mounting rail

Accessories

Box spanner

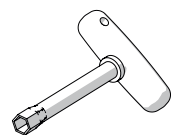

M8 / A/F 13;
For actuating the central lock

Art. No.

222430

Breather

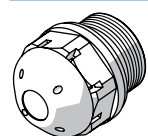

Thread: M25 x 1.5 (20 pieces); without jam nut

Art. No.

285780

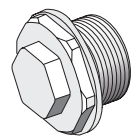

Thread: M25 x 1.5 (1 piece); for installation in light fittings; made from stainless steel; without jam nut

296608

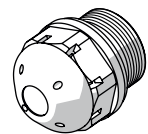

M25 x 1.5 in order to avoid condensate formation

115738

Ceiling and wall mounting bracket

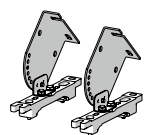

mounted on a mounting rail for a variable mounting distance; Material: stainless steel; Lamp can be swiveled in steps of 15°; 1 pair

Art. No.

222827

Mounting bracket

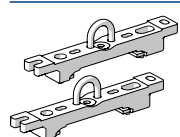

mounting clamp mounted on a mounting rail for a variable mounting distance; 1 pair

Art. No.

222456

Mounting rail

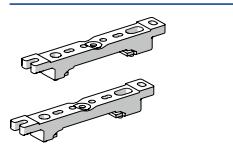
	for a variable mounting distance; 1 pair	Art. No. 222826
--	--	--------------------

Pipe clamp

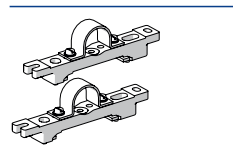
	R 1 1/2"; with mounting rail for a variable mounting distance; material: stainless steel; 1 pair	Art. No. 222459
	R 1 1/4"; with mounting rail for a variable mounting distance; Material: stainless steel; 1 pair	222458
	R 2"; with mounting rail for a variable mounting distance; Material: stainless steel; 1 pair	222460

Pole mounting

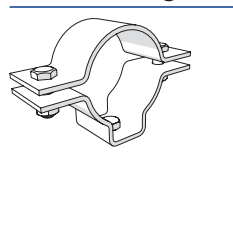
	Pole mounting acces. 1.4301 ø38mm-1 pair	Art. No. 324916
	Pole mounting acces. 1.4301 ø42mm-1 pair	324914
	Pole mounting acces. 1.4301 ø50mm-1 pair	324915
	Pole mounting acces. 1.4301 ø60mm-1 pair	324912
	Pole mounting acces. 1.4404 ø50mm-1 pair	324917
	Pole mounting acces. 1.4404 ø60mm-1 pair	324913

Pole mounting sleeve

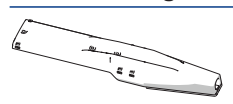
	for the subsequent mounting on lights size 2 and size 4, completely with assembly parts (for pipe diameter 42 mm)	Art. No. 227512
--	---	--------------------

Ring bolt

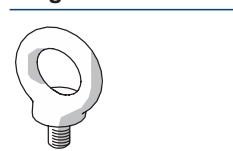
	M8, direct mounting in insert nuts; 1 pair	Art. No. 115736
--	--	--------------------

Wall mounting

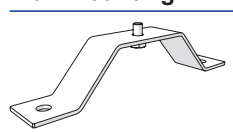
	Wall/ceiling mtg.bkt. 1.4301w-1pair	Art. No. 324918
--	-------------------------------------	--------------------

Spare Parts

Cover

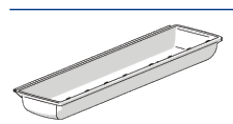
	for luminaire size 2	Art. No. 222427
--	----------------------	--------------------

We reserve the right to make alterations to the technical data, dimensions, weights, designs and products available without notice. The illustrations cannot be considered binding.