

# Lighting

## Emergency luminaire With LED

GRP

L409/4348-5101-160-0020-20-850011 Art. No. 331530



- Long-lasting LED version of the EXLUX family in an industrial design
- Robust, durable enclosure with central lock for use as humid lighting
- Integrated, automatically started test function for the integrated battery
- Up to 3 hours battery runtime with a luminous flux of 1000 lm in emergency operation
- Available with warm white, neutral white and cold white colour temperatures

### MY R. STAHL L409A

The EXLUX L409/4 light fitting completes the LED linear luminaire range. The industrial design of the emergency luminaires offers all the advantages of the robust enclosure technology and long-lasting LED technology for which the EXLUX range is known. This automatically starts all test functions set out as mandatory in standards and the ergonomic light fitting device provides clear signals. The entire range of installation material for the EXLUX family is also available.

## Technical Data

Explosion Protection	
Ex version	Industrial design
Electrical Data	
Rated operational voltage AC	110 ... 240 V
Battery version	NiCd battery, gas-tight
Battery operating voltage	6 V
Battery capacity	7 Ah
Self-test function	With (standard)
Frequency range	50 – 60 Hz
Lighting Data	
Number of lamps	1
Lamp wattage	45 W
Lamp	LED
Light colour	5000 K – neutral white
Light distribution	120°x120° with diffusing glass
Luminaire efficacy	129 lm/W
Luminous flux	5810 lm
Operating time	1.5h emergency lighting operation
Emergency light output	35% – 1.5 h
Colour rendering	≥ 80
Colour temperature	5000 K
Ambient Conditions	
Ambient temperature	-30 °C ... +60 °C
Mechanical Data	
Version	Standard
IP degree of protection (IEC 60598)	IP66/IP67
Enclosure material	Polyester resin, Glass fibre reinforced

# Lighting

## Emergency luminaire With LED

### GRP

L409/4348-5101-160-0020-20-850011 Art. No. 331530

STAHL

#### Mechanical Data

Enclosure colour	Light grey (RAL 7035)
Diffuser	With diffuser
Sealing material	Silicone
Silicone-free content	Contains silicone
Translucent cover material	Polycarbonate
Installed terminal strip	PE + N + L1 + L2 + L3 + L'
Max. solid connection terminals	6 mm <sup>2</sup>
Max. finely stranded connection terminals	4 mm <sup>2</sup>
Type of connection cable	Finely stranded Solid
Size	4
Width	183.5 mm
Height	125 mm
Length	1467 mm
Impact strength (IEC 62262)	IK10
Weight	8.1 kg
Weight	17.86 lb
Disconnection of the luminaire	Only battery

#### Components

Threaded plate	1x SS430 stainless steel
Ballast	LED NLE 80W 110-240V/7Ah/1.5h/
Through wiring	without
Drilled holes	1 x M20
Cable glands and entries	can be ordered as an accessory
Stopping plugs	Can be ordered as accessories
Accessories	without

#### Dimensional Drawings (All Dimensions in mm [inches]) – Subject to Alterations

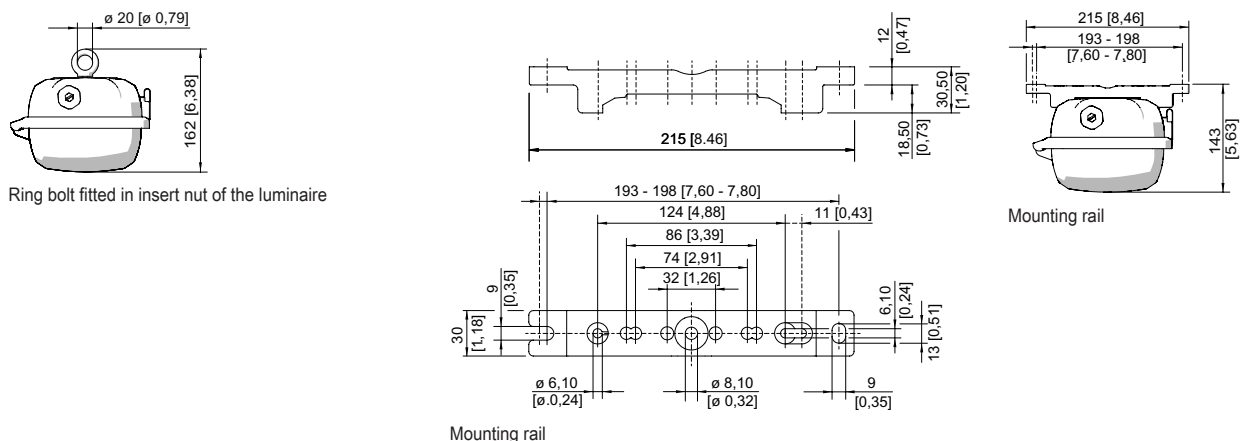

# Lighting

## Emergency luminaire With LED

### GRP

L409/4348-5101-160-0020-20-850011 Art. No. 331530

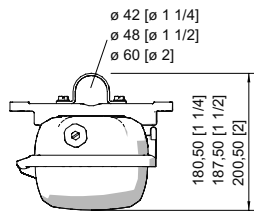

Pipe clamp fitted in mounting rail

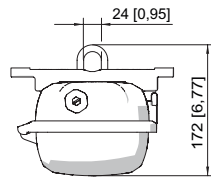

Mounting bracket fitted in mounting rail

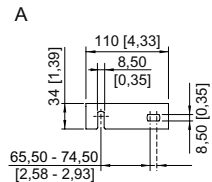
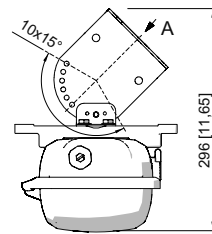

Wall mounting bracket fitted in mounting rail

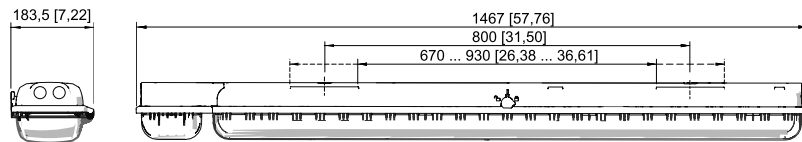

Size 4

## Accessories

### Box spanner

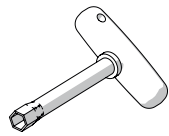

M8 / A/F 13;  
For actuating the central lock

Art. No.

222430

### Breather

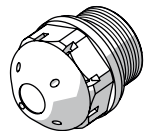

Thread: M25 x 1.5 (20 pieces); without jam nut

Art. No.

285780

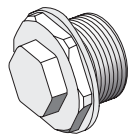

Thread: M25 x 1.5 (1 piece); for installation in light fittings; made from stainless steel; without jam nut

Art. No.

296608

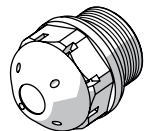

M25 x 1.5 in order to avoid condensate formation

Art. No.

115738

### Ceiling and wall mounting bracket

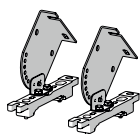

mounted on a mounting rail for a variable mounting distance; Material: stainless steel; Lamp can be swiveled in steps of 15°; 1 pair

Art. No.

222827

# Lighting

## Emergency luminaire With LED

GRP

L409/4348-5101-160-0020-20-850011 Art. No. 331530



### Holder for translucent cover

Art. No.



The fall prevention system for the light fitting cover prevents the light fitting cover from falling accidentally when the light fitting is opened.

226791

### Mounting bracket

Art. No.

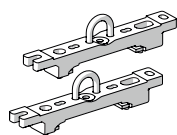

mounting clamp mounted on a mounting rail for a variable mounting distance; 1 pair

222456

### Mounting rail

Art. No.

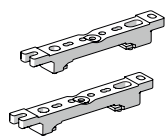

for a variable mounting distance; 1 pair

222826

### Pipe clamp

Art. No.

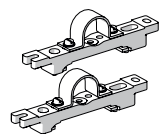

R 1 1/2"; with mounting rail for a variable mounting distance; material: stainless steel; 1 pair

222459

R 1 1/4"; with mounting rail for a variable mounting distance; Material: stainless steel; 1 pair

222458

R 2"; with mounting rail for a variable mounting distance; Material: stainless steel; 1 pair

222460

### Pole mounting sleeve

Art. No.



for the subsequent mounting on lights size 2 and size 4, completely with assembly parts (for pipe diameter 42 mm)

227512

### Protection against accidental contact

Art. No.

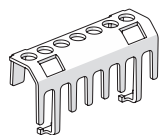

The protection against accidental contact prevents maintenance technicians and electrical installers from accidentally touching conductive parts. The degree of protection is increased to IP20 when the protection against accidental contact is used.

283153

## Spare Parts

### Cover

Art. No.

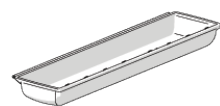

for luminaire size 4

222428

### Contact element

Art. No.

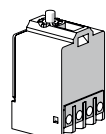

8080/1-3-L 2 NC contact element

132527

# Lighting

Emergency luminaire With LED

GRP

L409/4348-5101-160-0020-20-850011 Art. No. 331530



## Battery set

## Art. No.

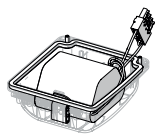

Battery cover with built-in battery. Gas-tight NiCd battery; 7 Ah / 6 V

223532

We reserve the right to make alterations to the technical data, dimensions, weights, designs and products available without notice. The illustrations cannot be considered binding.