

# Lighting

## Emergency luminaire With LED

GRP

6209/1143-0201-162-2220-22-75711 Art. No. 342119



- Smart Central Locking System – Allows effortless access for quick maintenance, minimizing downtime and enhancing operational efficiency.
- Wide Voltage of 100 to 277 V AC – Makes the light fixtures suitable for different applications & environment.
- Advanced Surge Protection up to 6KV – Engineered for resilience, the robust design shields the luminaire from electrical surges, ensuring long-lasting performance.
- Emergency Light Output - Ensures essential visibility during evacuation or system restoration.
  - i. 2 ft model: Up to 65% brightness for 1.5h or 35% for 3h.
  - ii. 4 ft model: Up to 35% brightness for 1.5h or 20% for 3h.
- Long- Lasting LED Performance – Designed for durability, the luminaire delivers over 1,00,000 hours (L70B50) of service life even in +55°C ambient conditions.

MY R. STAHL 6209A

The emergency luminaire with Series 6209/1 LED with integrated battery can be installed in stand-by switching, continuous mode or in switchable stand-by switching. A monthly functional test and annual rated operating time test are performed automatically. The results are indicated by an LED.

### Technical Data

#### Explosion Protection

Ex version	Yes
Application range (zones)	1, 2, 21, 22
IECEX gas certificate	IECEX EPS 25.0020X
IECEX gas explosion protection	Ex db eb ib mb IIC T4
IECEX dust certificate	IECEX EPS 25.0020X
IECEX dust explosion protection	Ex tb IIIC T80 °C Db
Certificates and approvals	IECEX
Certificates	IECEX (BVIS)

#### Electrical Data

Battery version	NiCd battery, gas-tight
Battery operating voltage	7.2 V
Battery capacity	5 Ah
Self-test function	With (standard)
Control gear service life	C10 ≥ 50 h, Ta ≤ 55 °C
LED service life	L70B50 ≥ 100 h

#### Lighting Data

Number of lamps	1
Lamp wattage	50 W
Lamp	LED
Light colour	5700 K – cool white
Light distribution	120°x120° with diffusing glass
Luminaire efficacy	120 lm/W
Luminous flux	5999 lm
Operating time	3h emergency lighting operation
Emergency light output	25% – 3 h

# Lighting

## Emergency luminaire With LED

### GRP

6209/1143-0201-162-2220-22-75711 Art. No. 342119



#### Lighting Data

Colour rendering	≥ 70
Colour temperature	5700 K

#### Mechanical Data

Version	Standard
IP degree of protection (IEC 60598)	IP66/IP67
Enclosure material	Polyester resin, Glass fibre reinforced
Enclosure colour	Light grey (RAL 7035)
Diffuser	With diffuser
Sealing material	Silicone
Silicone-free content	Contains silicone
Translucent cover material	Polycarbonate
Installed terminal strip	PE + N + L1 + L2 + L3 + L´
Max. solid connection terminals	6 mm <sup>2</sup>
Max. finely stranded connection terminals	4 mm <sup>2</sup>
Type of connection cable	Finely stranded Solid
Size	4
Width	184 mm
Height	125 mm
Length	1310 mm
Impact strength (IEC 62262)	IK10
Weight	9 kg
Weight	19.84 lb
Disconnection of the luminaire	Only battery

#### Components

Threaded plate	2x stainless steel
Ballast	6049/111-110-10 + 6246/111-1
Through wiring	With 6 conductors 2.5 mm <sup>2</sup>
Drilled holes	3 x M20
Cable glands and entries	can be ordered as an accessory
Stopping plugs	Can be ordered as accessories
Accessories	without

#### Dimensional Drawings (All Dimensions in mm [inches]) – Subject to Alterations

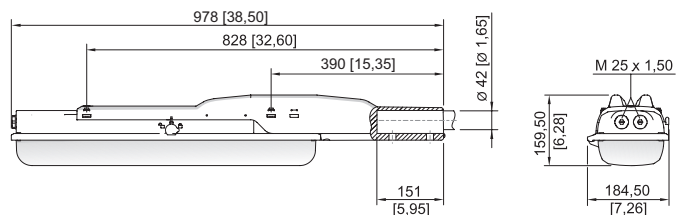

Size 2

# Lighting

## Emergency luminaire With LED

### GRP

6209/1143-0201-162-2220-22-75711 Art. No. 342119

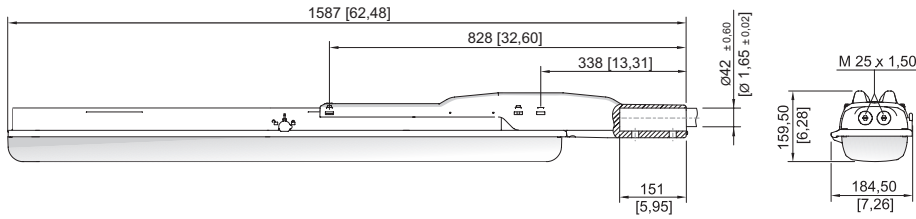

Size 4

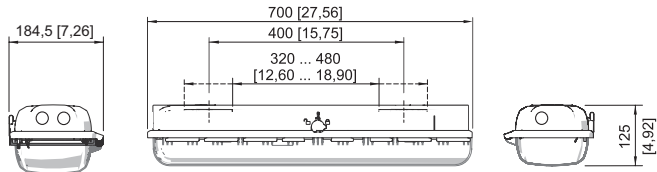

Size 2

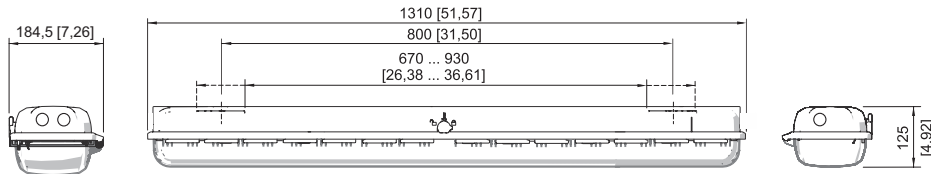

Size 4

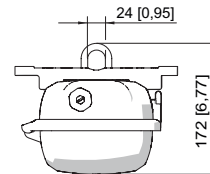

Mounting bracket fitted in mounting rail

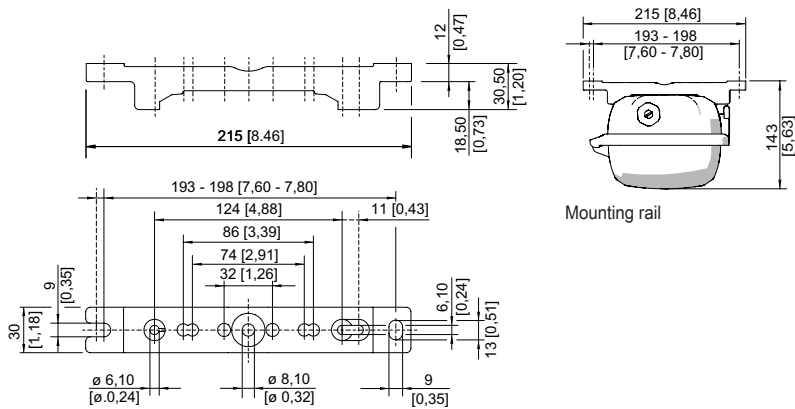

Mounting rail

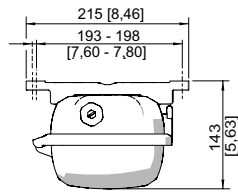

Mounting rail

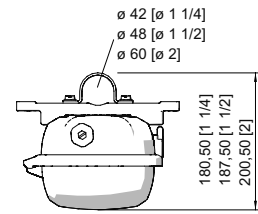

Pipe clamp fitted in mounting rail

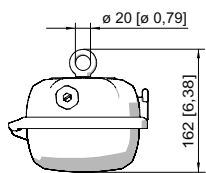

Ring bolt fitted in insert nut of the luminaire

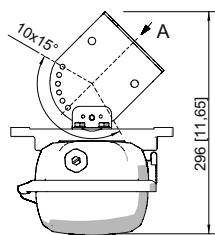

A

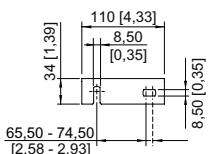

Wall mounting bracket fitted in mounting rail

# Lighting

## Emergency luminaire With LED

GRP

6209/1143-0201-162-2220-22-75711 Art. No. 342119



### Accessories

#### Box spanner

Art. No.

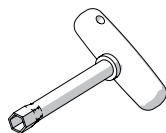

M8 / A/F 13;  
For actuating the central lock

222430

#### Breather

Art. No.

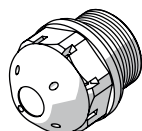

Thread: M25 x 1.5 (20 pieces); without jam nut

285780

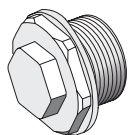

Thread: M25 x 1.5 (1 piece); for installation in light fittings; made from stainless steel; without jam nut

296608

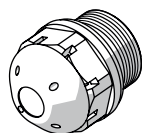

M25 x 1.5 in order to avoid condensate formation

115738

#### Ceiling and wall mounting bracket

Art. No.

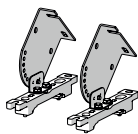

mounted on a mounting rail for a variable mounting distance; Material: stainless steel; Lamp can be swiveled in steps of 15°; 1 pair

222827

#### Mounting bracket

Art. No.

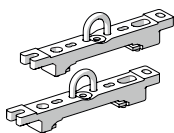

mounting clamp mounted on a mounting rail for a variable mounting distance; 1 pair

222456

#### Mounting rail

Art. No.

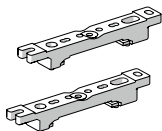

for a variable mounting distance; 1 pair

222826

#### Pipe clamp

Art. No.

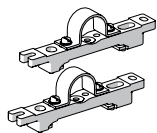

R 1 1/2"; with mounting rail for a variable mounting distance; material: stainless steel; 1 pair

222459

R 1 1/4"; with mounting rail for a variable mounting distance; Material: stainless steel; 1 pair

222458

R 2"; with mounting rail for a variable mounting distance; Material: stainless steel; 1 pair

222460

# Lighting

## Emergency luminaire With LED

GRP

6209/1143-0201-162-2220-22-75711 Art. No. 342119

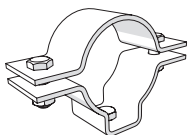

### Pole mounting

	Art. No.	
	Pole mounting acces. 1.4301 $\varnothing$ 38mm-1 pair	324916
	Pole mounting acces. 1.4301 $\varnothing$ 42mm-1 pair	324914
	Pole mounting acces. 1.4301 $\varnothing$ 50mm-1 pair	324915
	Pole mounting acces. 1.4301 $\varnothing$ 60mm-1 pair	324912
	Pole mounting acces. 1.4404 $\varnothing$ 50mm-1 pair	324917
	Pole mounting acces. 1.4404 $\varnothing$ 60mm-1 pair	324913

### Pole mounting sleeve

	Art. No.
 for the subsequent mounting on lights size 2 and size 4, completely with assembly parts (for pipe diameter 42 mm)	227512

### Ring bolt

	Art. No.
 M8, direct mounting in insert nuts; 1 pair	115736

### Wall mounting

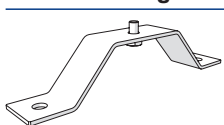
	Art. No.
 Wall/ceiling mtg.bkt. 1.4301w-1pair	324918

## Spare Parts

### Cover

	Art. No.	
	for luminaire size 4	222428
	for luminaire size 2	222427

We reserve the right to make alterations to the technical data, dimensions, weights, designs and products available without notice. The illustrations cannot be considered binding.