

# Installation equipment and accessories

## Cable gland with multiple sealing insert

Green

8161/8-M25-9999-MFD-04045 Art. No. 265086

STAHL



- For safely running cables into Ex e and Ex i areas
- Can be used in a temperature range from -60 to +75 °C, degree of protection IP68
- Available in Ex e and Ex i versions; the Ex i version is identified by a blue cap nut
- Cable dia. ranges from 1 to 48 mm
- Versions with multi-seal inserts

MY R. STAHL 8161B



R. STAHL's Series 8161/7 and 8161/8 cable glands can be used to safely run cables into Ex e enclosures. They are suitable for cable diameters between 1 and 48 mm. They are available for Ex e and Ex i electrical circuits – the Ex i version can be distinguished by its blue cap nut. A stopping plug for unused entries can be integrated into the entries.

### Technical Data

#### Explosion Protection

|                                 |                        |
|---------------------------------|------------------------|
| Ex version                      | Ex i                   |
| Application range (zones)       | 1, 2, 21, 22           |
| IECEX gas certificate           | IECEX PTB 14.0011 X    |
| IECEX gas explosion protection  | Ex eb IIC Gb           |
| IECEX dust certificate          | IECEX PTB 14.0011 X    |
| IECEX dust explosion protection | Ex tb IIIC Db          |
| ATEX gas certificate            | PTB 14 ATEX 1008 X     |
| ATEX gas explosion protection   | ⊕ II 2 G Ex eb IIC Gb  |
| ATEX dust certificate           | PTB 14 ATEX 1008 X     |
| ATEX dust explosion protection  | ⊕ II 2 D Ex tb IIIC Db |

#### Ambient Conditions

|                      |                   |
|----------------------|-------------------|
| Ambient temperature  | -40 °C ... +75 °C |
| Use at the height of | < 2000 m          |

#### Mechanical Data

|                           |   |
|---------------------------|---|
| Version                   | Multiple seal   |
| Strain relief             | No  |
| Degree of protection (IP) | IP66  |
| Degree of protection note | IP68 at 5 bar 30 min. (IP protection according to IEC/EN 60529) |
| Sealing material          | EPDM profile seal   |
| Sealing ring material     | EPDM  |
| Material                  | Polyamide, Glass fibre reinforced                               |
| Silicone-free             | Yes   |
| Self-extinguishing        | Yes   |
| Flame-retardant           | Yes   |
| Halogen-free              | Yes   |
| Surface resistance        | $\leq 10^{13} \Omega$   |
| Number of cables          | 4   |

# Installation equipment and accessories

## Cable gland with multiple sealing insert

Green

8161/8-M25-9999-MFD-04045 Art. No. 265086



### Mechanical Data

|                             |                              |
|-----------------------------|------------------------------|
| Clamping range              | 4.1 – 4.5 mm                 |
| Armouring type              | Unarmoured cable types       |
| Cable entry                 | 1 x M25 – 4 x Ø 4,1 – 4,5 mm |
| Clamping range              | 4.1 ... 4.5 mm               |
| Total length                | 38 to 46 mm                  |
| Width across corners        | 32 mm                        |
| Width across flats          | 29 mm                        |
| Thread size                 | M25                          |
| Thread length               | 10 mm                        |
| Thread pitch                | 1,5 mm                       |
| Impact strength (IEC 60079) | 7 J                          |
| Impact strength             | 7 J                          |
| Colour                      | Blue                         |
| Lot size                    | 50                           |
| Weight                      | 20 g                         |
| Weight                      | 0.04 lb                      |

### Dimensional Drawings (All Dimensions in mm [inches]) – Subject to Alterations

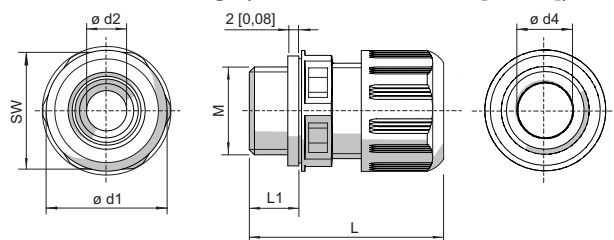

M = Thread size  
 SW = Width across flats  
 L1 = Thread length  
 L = Total length

### Cable glands without bend protection

| Thread size | Width across flats | Total length | Total length (with long thread) | Thread length | Thread length (long thread) | Clamping range | Clamping range + reduction sealing insert | Dimension d1 | Dimension d2 | Dimension d4 |
|-------------|--------------------|--------------|---------------------------------|---------------|-----------------------------|----------------|---|--------------|--------------|--------------|
| M12         | 16.00 mm           | 29 to 34 mm  | 35 to 40 mm                     | 9 mm          | 15 mm                       | 3 - 6 mm       | 1 - 6 mm                                  | 18 mm        | 7.3 mm       | 6.3 mm       |
| M16         | 20.00 mm           | 31 to 37 mm  | 37 to 43 mm                     | 9 mm          | 15 mm                       | 5 - 9 mm       | 2 - 9 mm                                  | 22 mm        | 10.3 mm      | 9.3 mm       |
| M20         | 24.00 mm           | 36 to 43 mm  | 41 to 48 mm                     | 10 mm         | 15 mm                       | 7 - 13 mm      | 4 - 13 mm                                 | 27 mm        | 13.3 mm      | 13.3 mm      |
| M25         | 29.00 mm           | 38 to 46 mm  | 43 to 51 mm                     | 10 mm         | 15 mm                       | 10 - 17 mm     | 7 - 17 mm                                 | 32 mm        | 17.3 mm      | 17.3 mm      |
| M32         | 36.00 mm           | 42 to 50 mm  | 45 to 53 mm                     | 12 mm         | 15 mm                       | 13 - 21 mm     | 9 - 21 mm                                 | 40 mm        | 21.3 mm      | 21.3 mm      |
| M40         | 46.00 mm           | 52 to 65 mm  | 58 to 71 mm                     | 12 mm         | 18 mm                       | 17 - 28 mm     | 12 - 28 mm                                | 51 mm        | 28.3 mm      | 30 mm        |
| M50         | 55.00 mm           | 59 to 72 mm  | 63 to 76 mm                     | 14 mm         | 18 mm                       | 23 - 35 mm     | 16 - 35 mm                                | 61 mm        | 35.3 mm      | 40 mm        |

# Installation equipment and accessories

Cable gland with multiple sealing insert

Green

8161/8-M25-9999-MFD-04045 Art. No. 265086



---

|     |             |                |                |       |       |            |            |       |            |          |
|-----|-------------|----------------|----------------|-------|-------|------------|------------|-------|------------|----------|
| M63 | 68.00<br>mm | 64 to 78<br>mm | 67 to 81<br>mm | 15 mm | 18 mm | 34 - 48 mm | 28 - 48 mm | 75 mm | 48.3<br>mm | 53<br>mm |
|-----|-------------|----------------|----------------|-------|-------|------------|------------|-------|------------|----------|

---

We reserve the right to make alterations to the technical data, dimensions, weights, designs and products available without notice. The illustrations cannot be considered binding.