



- The latest LED technology with a high luminous efficacy and a long service life
- Extremely high luminaire efficacy
- Can be adjusted from a 1.5 to a 3.0 h rated operating time
- Luminous flux after 100,000 h still 90% of the starting luminous flux
- Optionally with DALI for controlling and monitoring the luminaire
- Automatic weekly function test and annual rated operating time test

MY R. STAHL 6409C



The emergency luminaire with Series 6409/4 LED with integrated battery can be installed in stand-by switching, continuous mode or in switchable stand-by switching. A weekly functional test and annual rated operating time test are performed automatically. The results are indicated by an LED.

Technical Data

Explosion Protection	
Ex version	Yes
Application range (zones)	2, 21, 22
IECEX gas certificate	IECEX IBE 16.0047
IECEX gas certificate	IECEX IBE 16.0047
IECEX gas explosion protection	Ex db ec IIC T4 Gc
IECEX dust certificate	IECEX IBE 16.0047
IECEX dust explosion protection	Ex tb op is / tc IIIC T100 °C Db
ATEX gas certificate	IBExU 16 ATEX 1233
ATEX gas certificate	IBExU 16 ATEX 1233
ATEX gas explosion protection	⊕ II 3 G Ex db ec IIC T4 Gc
ATEX dust certificate	IBExU 16 ATEX 1233
ATEX dust explosion protection	⊕ II 2 D Ex tb op is / tc IIIC T100 °C Db
Certificates and approvals	ATEX IECEX UKEX
Certificates	ATEX (IBE), IECEX (IBE), India (PESO)
Declaration of conformity	ATEX (EUK), Declaration of Conformity (AUS)
Electrical Data	
Rated operational voltage AC	110 ... 240 V
Battery version	NiCd battery, gas-tight
Battery operating voltage	6 V
Battery capacity	7 Ah
Self-test function	With (standard)
Frequency range	50 – 60 Hz
Lighting Data	
Number of lamps	1
Lamp wattage	25 W
Lamp	LED

Lighting

Emergency luminaire With LED

GRP

6409/4128-5101-162-1110-11-850011 Art. No. 271816



Lighting Data

Light colour	5000 K – neutral white
Light distribution	120°x120° with diffusing glass
Luminaire efficacy	116 lm/W
Luminous flux	2910 lm
Operating time	1.5h emergency lighting operation
Emergency light output	65% – 1.5 h
Colour rendering	≥ 80
Colour temperature	5000 K

Ambient Conditions

Ambient temperature	-30 °C ... +50 °C Note: Through wiring Max. 3x16 A -30 °C ... +55 °C Note: Through wiring 2 Max. 3x10 A
---------------------	--

Mechanical Data

Version	Standard
IP degree of protection (IEC 60598)	IP66/IP67
Enclosure material	Polyester resin, Glass fibre reinforced
Enclosure colour	Light grey (RAL 7035)
Diffuser	With diffuser
Sealing material	Silicone
Silicone-free content	Contains silicone
Translucent cover material	Polycarbonate
Installed terminal strip	PE + N + L1 + L2 + L3 + L´
Max. solid connection terminals	6 mm ²
Max. finely stranded connection terminals	4 mm ²
Type of connection cable	Finely stranded Solid
Size	2
Width	183.5 mm
Height	125 mm
Length	857 mm
Impact strength (IEC 62262)	IK10
Weight	5.4 kg
Weight	11.9 lb
Disconnection of the luminaire	Only battery

Components

Threaded plate	2x plastic
Ballast	LED NLE 80W 110-240V/7Ah/1.5h/
Through wiring	With 6 conductors 2.5 mm ²
Drilled holes	3 x M25
Cable glands and entries	2 x M25 Ø 7 ... 17 mm
Material cable gland	Polyamide, black
Stopping plugs	2 x M25 x 1.5
Stopping plug material	Polyamide, black
Cable entry material	Polyamide, black
Accessories	Provided

Lighting

Emergency luminaire With LED

GRP

6409/4128-5101-162-1110-11-850011 Art. No. 271816



Dimensional Drawings (All Dimensions in mm [inches]) – Subject to Alterations

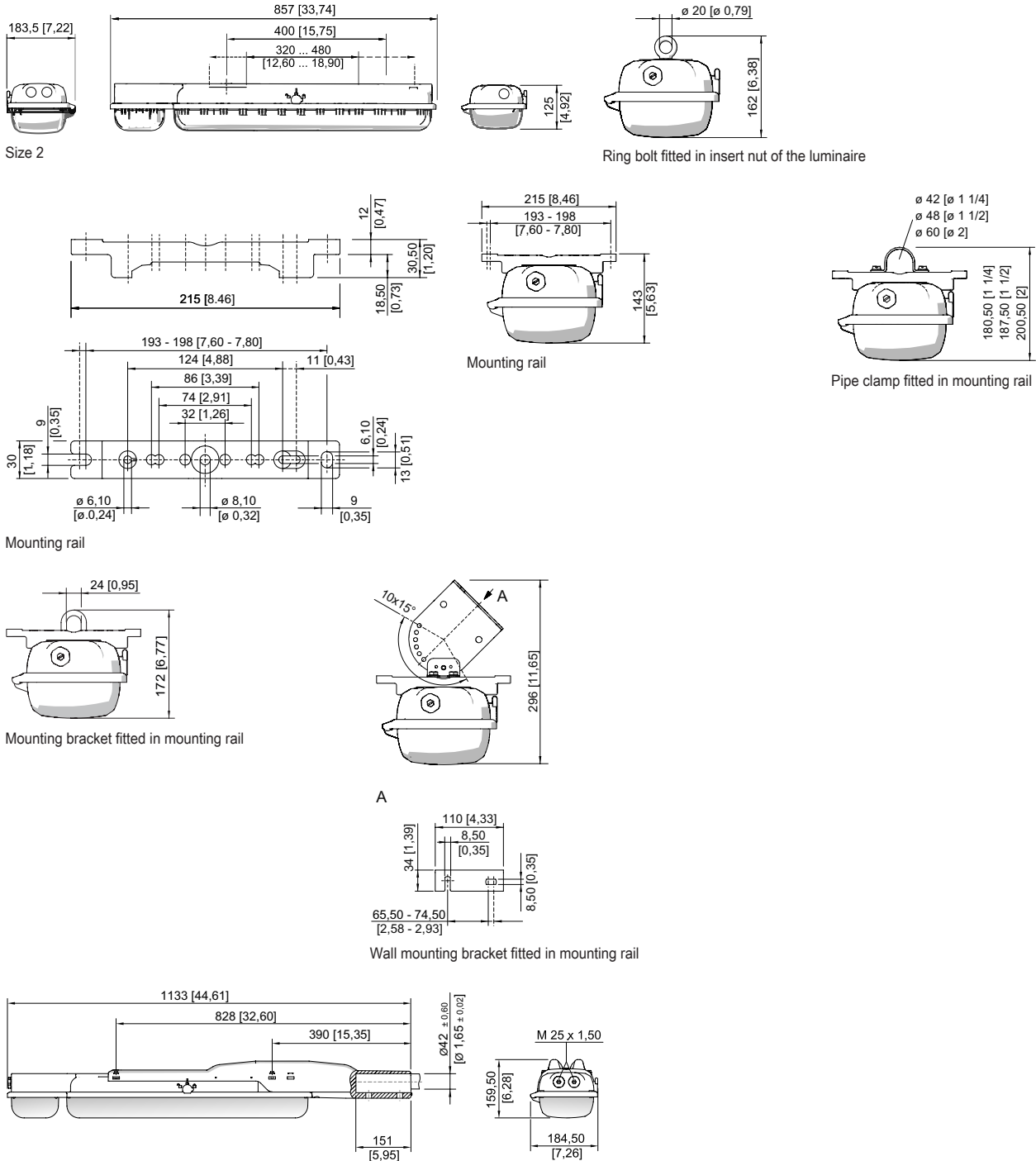

Size 2

Accessories

Breather

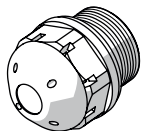

Thread: M25 x 1.5 (20 pieces); without jam nut

Art. No.

285780



Lighting

Emergency luminaire With LED

GRP

6409/4128-5101-162-1110-11-850011 Art. No. 271816

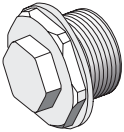
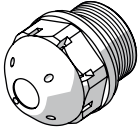

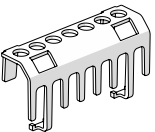
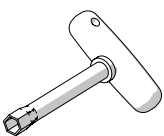
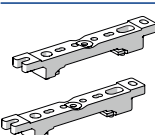
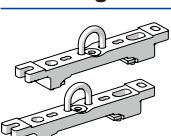
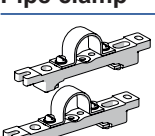
	Thread: M25 x 1.5 (1 piece); for installation in light fittings; made from stainless steel; without jam nut	296608
	M25 x 1.5 in order to avoid condensate formation	115738
Holder for translucent cover		Art. No.
	The fall prevention system for the light fitting cover prevents the light fitting cover from falling accidentally when the light fitting is opened.	226791
Pole mounting sleeve		Art. No.
	for the subsequent mounting on lights size 2 and size 4, completely with assembly parts (for pipe diameter 42 mm)	227512
Protection against accidental contact		Art. No.
	The protection against accidental contact prevents maintenance technicians and electrical installers from accidentally touching conductive parts. The degree of protection is increased to IP20 when the protection against accidental contact is used.	283153
Box spanner		Art. No.
	M8 / A/F 13; For actuating the central lock	222430
Mounting rail		Art. No.
	for a variable mounting distance; 1 pair	222826
Mounting bracket		Art. No.
	mounting clamp mounted on a mounting rail for a variable mounting distance; 1 pair	222456
Pipe clamp		Art. No.
	R 1 1/2"; with mounting rail for a variable mounting distance; material: stainless steel; 1 pair	222459
	R 1 1/4"; with mounting rail for a variable mounting distance; Material: stainless steel; 1 pair	222458
	R 2"; with mounting rail for a variable mounting distance; Material: stainless steel; 1 pair	222460

Lighting

Emergency luminaire With LED

GRP

6409/4128-5101-162-1110-11-850011 Art. No. 271816



Ring bolt

Art. No.



M8, direct mounting in insert nuts; 1 pair

115736

Ceiling and wall mounting bracket

Art. No.

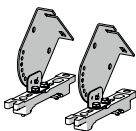

mounted on a mounting rail for a variable mounting distance; Material: stainless steel; Lamp can be swiveled in steps of 15°; 1 pair

222827

Spare Parts

Cover

Art. No.

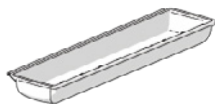

for luminaire size 2

222427

Contact element

Art. No.

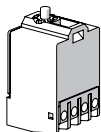

8080/1-3-L 2 NC contact element

132527

Battery set

Art. No.

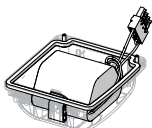

Battery cover with built-in battery. Gas-tight NiCd battery; 7 Ah / 6 V

223532

We reserve the right to make alterations to the technical data, dimensions, weights, designs and products available without notice. The illustrations cannot be considered binding.