

8510/141-03-606-130 Art. No. 273745



- Type-tested standard components with up to seven contacts
- Robust: Vibration-proof components in the corrosion-resistant enclosure
- Easily accessible terminals for a safe connection and simple installation

MY R. STAHL 8510M



R. STAHL Series 8510 auxiliary contacts are fitted with up to seven contacts. They are screwed into the enclosure so that they are protected against vibrations. They are also low-maintenance and reliable. Easily accessible terminals make installation simple and safe. Their enclosure is made of corrosion-resistant material.

Technical Data

Explosion Protection	
Application range (zones)	1, 2
IECEX gas certificate	IECEX BVS 07.0029U
IECEX gas explosion protection	Ex de IIC
IECEX firedamp certificate	IECEX BVS 07.0029U
IECEX firedamp protection	Ex de I
ATEX gas certificate	DMT 00 ATEX E 073 U
ATEX gas explosion protection	Ex II 2 G Ex de IIC
ATEX firedamp certificate	DMT 00 ATEX E 073 U
ATEX firedamp protection	Ex I M2 Ex de I
Certificates	ATEX (BVS), Brazil (ULB), Canada (FM), China (CQST), IECEX (BVS), USA (FM)
Electrical Data	
Rated actuating voltage	230 V AC
Auxiliary contacts	4 (2 NO + 2 NC)
Ambient Conditions	
Ambient temperature	-20 °C ... +60 °C
Mechanical Data	
Degree of protection (IP)	IP20
Enclosure material	Epoxy resin
Max. AUXCON con. cr.-sec solid	2.5 mm ²
Connection cross-section auxiliary contact solid min.	0.75 mm ²
Max. auxiliary contact connection cross section, finely stranded	1.5 mm ²
Connection cross-section auxiliary contact finely stranded min.	0.75 mm ²
Width	80 mm
Height	130 mm

8510/141-03-606-130 Art. No. 273745

Mechanical Data

Depth	110.5 mm
Weight	1.33 kg
Weight	2.93 lb

Technical Drawings – Subject to Alterations

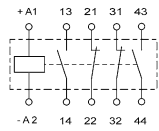

2 NO + 2 NC

Dimensional Drawings (All Dimensions in mm [inches]) – Subject to Alterations

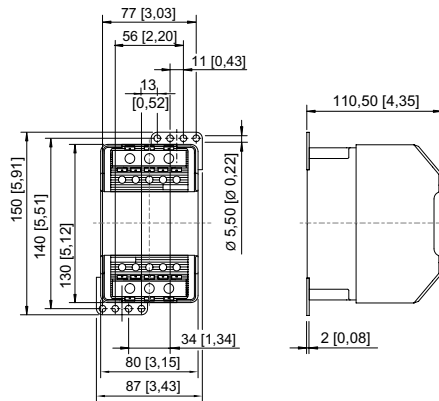

8510/141

We reserve the right to make alterations to the technical data, dimensions, weights, designs and products available without notice. The illustrations cannot be considered binding.