

Isolator Barriers

Binary output

Ex i field circuit

9275/10-21-25-11s Art. No. 261434

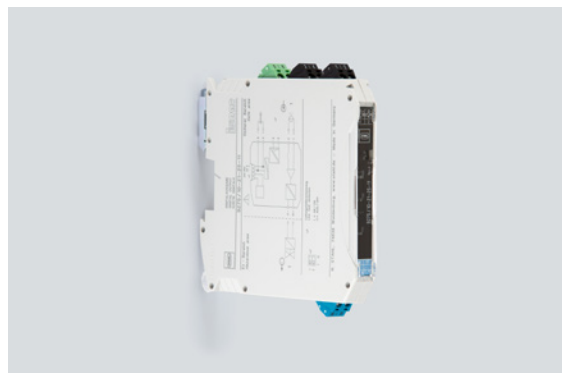

- Space savings due to a slim design – 12.5 mm wide
- Can be used for functional safety levels up to SIL 3 (IEC/EN 61508)
- Offers line fault detection with signalization
- For interface with solenoid valves and LEDs

MY R. STAHL 9275A



Series 9275 digital outputs issue signals for the intrinsically safe operation of Ex i solenoid valves, indicator lamps or horns. The devices feature three-way galvanic separation.

Technical Data

Explosion Protection

Application range (zones)	2
Ex interface zone	0, 1, 2, 20, 21, 22
IECEX gas certificate	IECEX IBE 17.0044X
IECEX gas certificate	IECEX IBE 17.0044X
IECEX gas explosion protection	Ex ec [ia Ga] IIC T4 Gc
IECEX dust certificate	IECEX IBE 17.0044X
IECEX dust explosion protection	[Ex ia Da] IIIC
IECEX firedamp certificate	IECEX IBE 17.0044X
IECEX firedamp protection	[Ex ia Ma] I
ATEX gas certificate	IBExU 17 ATEX 1152 X
ATEX gas certificate	IBExU 17 ATEX 1152 X
ATEX gas explosion protection	⊕ II 3 (1) G Ex ec [ia Ga] IIC T4 Gc
ATEX dust certificate	IBExU 17 ATEX 1152 X
ATEX dust explosion protection	⊕ II (1) D [Ex ia Da] IIIC
ATEX firedamp certificate	IBExU 17 ATEX 1152 X
ATEX firedamp protection	⊕ I (M1) [Ex ia Ma] I
cULus certificate	E81680
Marking cULus	Class I, Div. 2, Groups A,B,C,D; Class I, Zone 2, AEx/Ex nA Group IIC AIS Class I,II,III, Div. 1, Groups A,B,C,D,E,F,G; Class I, Zone 0, [AEx ia]/[Ex ia] IIC T4 any mounting pos. Ta = 60°C See Doc. 9275 6 031 001 3
Certificates	ATEX (IBE), Canada (UL), China (CQM), IECEX (IBE), India (PESO), Korea (KTL), SIL (BVS), USA (UL)
Ship approval	DNV
Declaration of conformity	ATEX (EUK), China (CCC)

Safety Data

Max. voltage U_0/V_{oc}	23.98 V
---------------------------	---------

Isolator Barriers

Binary output

Ex i field circuit

9275/10-21-25-11s Art. No. 261434



Safety Data

Max. current I_o (Ex ia)	37.4 mA
Max. power P_o	224 mW
Max. permissible external capacitance C_o/C_a for IIC	0.11 μ F
Max. permissible external inductance L_o/L_a for IIC	22 mH
Max. permissible external capacitance C_o/C_a for IIB	0.91 μ F
Max. permissible external inductance L_o/L_a for IIB	100 mH
Max. permissible external capa.IIA	3.33 μ F
Max. permissible external inductance L_o for IIA	200 mH
Max. permissible external capacity C_o for IIIC	0.91 μ F
Max. permissible external inductance L_o for IIIC	100 mH
Max. permissible external capacity C_o for I	3.33 μ F
Max. permissible external inductance L_o for I	200 mH
Internal capacitance	11 nF
Internal inductance	Negligible
Safety-related max. voltage	253 V AC
Intrinsically safe limiting values inductance L_o /capacitance C_o	Jointly connectable inductance L_o /capacitance C_o

IIC	L_o [mH]	20 mH	10 mH	5 mH	2 mH	0.500 mH
	C_o [μ F]	0.068 μ F	0.068 μ F	0.068 μ F	0.068 μ F	0.089 μ F
IIB	L_o [mH]	100 mH	20 mH	1 mH	0.100 mH	
	C_o [μ F]	0.300 μ F	0.480 μ F	0.510 μ F	0.890 μ F	
IIA	L_o [mH]	50 mH	20 mH	1 mH	0.500 mH	0.200 mH
	C_o [μ F]	0.670 μ F	0.760 μ F	0.760 μ F	0.830 μ F	0.890 μ F
IIIC	L_o [mH]	100 mH	20 mH	1 mH	0.100 mH	
	C_o [μ F]	0.300 μ F	0.480 μ F	0.510 μ F	0.890 μ F	
I	L_o [mH]	50 mH	20 mH	1 mH	0.500 mH	0.200 mH
	C_o [μ F]	0.670 μ F	0.760 μ F	0.760 μ F	0.830 μ F	0.890 μ F

Functional Safety

SIL	3
HFT	0
SFF	94,82%
Lambda SD	0 FIT
Lambda SU	406 FIT
Lambda DD	45,1 FIT
Lambda DU	24,6 FIT
Lambda, total	683 FIT
PFD_{avg} at T_{proof} 1 year	1,08E-04
PFD_{avg} at T_{proof} 2 years	2,16E-04

Isolator Barriers

Binary output

Ex i field circuit

9275/10-21-25-11s Art. No. 261434



Functional Safety

PFD_{avg} at T_{proof} 5 years 5,41E-04

PFDavg at T_{proof} 10 years 1,08E-03

Electrical Data

Number of channels 1

LFD relay Yes

Auxiliary Power

Auxiliary power 24 V DC

Auxiliary power voltage range 19.2 to 30 V

Nominal current 50 mA

Power consumption 1.2 W

Max. power dissipation 0.8 W

Polarity reversal protection Yes

Operation indication LED

Galvanic Isolation

Test voltage as per standard EN IEC 60079-11

Galvanic separation Ex i output to input 375 V AC peak value

Galvanic separation Ex i output to HE 375 V AC peak value

Galvanic separation Ex i output to FMC 375 V AC peak value

Test voltage as per standard EN 61010/EN 50178

Fault message contact to auxiliary power 300 V_{eff}

Input to auxiliary power 300 V_{eff}

Fault message contact to input 300 V_{eff}

Input

Input voltage for ON 15 – 30 V

Input voltage for OFF 0 – 5 V

Control current < 12 mA

Behaviour of the input with line fault 3000000 Ω

Output

Output open-circuit voltage U_a 21.1 V

Max. output current I_{a max} 25.1 mA

Output internal resistance R_i 641 Ω

Switching delay ON/OFF < 30 ms

Switching delay OFF/ON < 30 ms

Response time output < 30 ms

Switching state indication LED

LF switch user adjustment Activated/deactivated

Wire break. err detection OFF > 10 kΩ

Short circuit error detection output < 50 ohm

Test current < 0.6 mA

Test current note The test current is also active when line fault detection is deactivated

Line fault indication LED

Fault message contact switching capacity 30 V / 50 mA

Ambient Conditions

Ambient temperature °C
-20 °C ... +70 °C (Single device)
-20 °C ... +60 °C (Group assembly)

Isolator Barriers

Binary output

Ex i field circuit

9275/10-21-25-11s Art. No. 261434



Ambient Conditions

Ambient temperature °F	-4 °F ... +158 °F (Single device) -4 °F ... +140 °F (Group assembly)
Storage temperature °C	-40 °C ... +80 °C
Storage temperature °F	-40 °F ... +176 °F
Max. relative humidity	10 to 95%
Use at the height of	< 2000 m
Electromagnetic compatibility	EN 61326-1 Use in industrial environment Immunity according to EN 61000-6-2 Interference emission to EN 61000-6-4

Mechanical Data

Degree of protection (IP)	IP30
Degree of protection (IP) terminals	IP20
Fire resistance (UL 94)	V0
Enclosure material	Polyamide
Grid dimension	12.5 mm
Width	12.5 mm
Width, inches	0.49 in
Height	114.5 mm
Height in inches	4.51 in
Length	112.5 mm
Length in inches	4.43 in
Weight	160 g
Weight	0.35 lb

Mounting / Installation

Mounting type	DIN rail NS35/15, NS35/7.5
Mounting orientation	Vertical Horizontal
Connection type	Screw terminal
Min. rigid conductor cross section	0.2 mm ²
Max. rigid conductor cross section	2.5 mm ²
Min. flex conductor cross section	0.2 mm ²
Max. flex conductor cross section	2.5 mm ²
Connection cross-section AWG	24 ... 14

Technical Drawings – Subject to Alterations

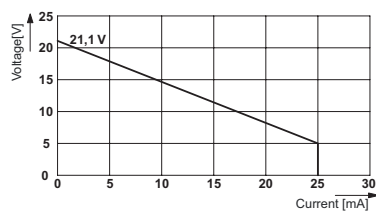
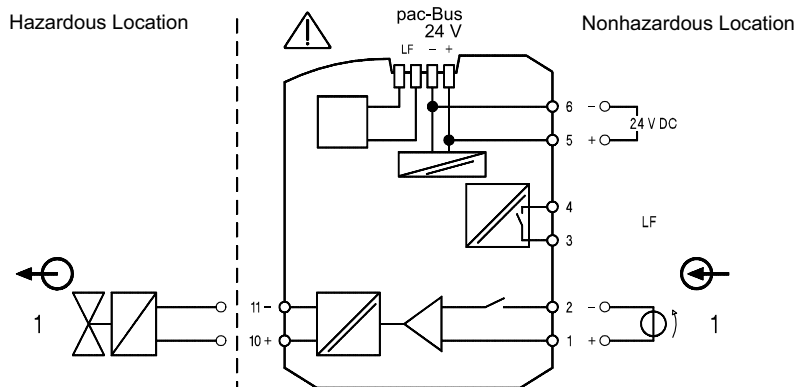

Output characteristic curve 9275/10-21-25-11

Connection diagram 9275/10

Isolator Barriers

Binary output

Ex i field circuit

9275/10-21-25-11s Art. No. 261434



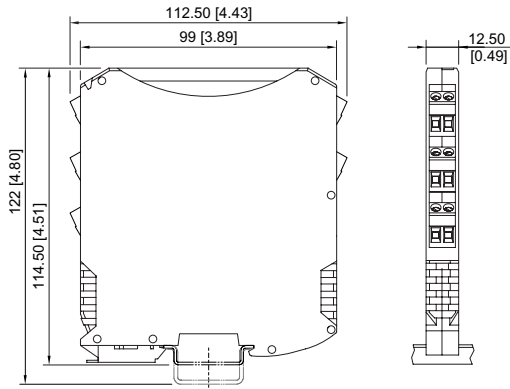

Dimensional Drawings (All Dimensions in mm [inches]) – Subject to Alterations



ISpac Series 9260, 9265, 9270, 9275, 9276, 9282
with screw terminal

Accessories

Supply module		Art. No.
	Redundant supply of 24 V DC auxiliary power (with fuse) and reading out the collective error message from Series 92xx ISpac modules which support this function. Screw terminal connection	268183
	Redundant supply of 24 V DC auxiliary power (with fuse) and reading out the collective error message from Series 92xx ISpac modules which support this function. Spring clamp terminal connection	268184
pac-Bus		Art. No.
	Wiring auxiliary power and collective error message	262928

We reserve the right to make alterations to the technical data, dimensions, weights, designs and products available without notice. The illustrations cannot be considered binding.